

# Operating Instructions



F01057y



## TERRALIGHT

TERRA-L series Ground Monitoring Device

BA-en-4013-2402





# List of contents

<b>1</b>	<b>Overview of Appliance</b>	
	<b>TERRA-L Ground Monitoring Device</b>	<b>5</b>
1.1	Components	6
1.2	Variants	6
<b>2</b>	<b>Safety</b>	<b>7</b>
2.1	Identification of risks and hazards	7
2.2	Technical advance	7
2.3	Proper use	7
2.4	Work and operational safety	8
2.5	Special arrangements according to the declaration of conformity	10
<b>3</b>	<b>Assembly and installation</b>	<b>11</b>
3.1	View of appliance TERRA-L	11
3.2	Assembly	12
3.3	Grounding	13
3.4	Electrical connection	13
3.4.1	Cable connection	14
3.4.2	Battery change / battery disposal	16
3.4.3	Connection TERRA-L	17
3.4.4	Configuring the sliding switch	18
3.5	Terminal assignments	19
<b>4</b>	<b>Operation</b>	<b>21</b>
4.1	Start-up	21
4.2	Function	21
4.3	Function control	22
4.4	Undervoltage warning	22
4.5	Battery life	22
<b>5</b>	<b>Maintenance</b>	<b>23</b>
5.1	Ground controls units	23
5.2	Ground clamps	23
5.3	Cable rewinders	23
<b>6</b>	<b>Troubleshooting</b>	<b>24</b>
<b>7</b>	<b>Technical specifications TERRA-L</b>	<b>25</b>
<b>8</b>	<b>Dimensions</b>	<b>26</b>
<b>9</b>	<b>Accessories and spare parts</b>	<b>28</b>
	<b>Declarations of Conformity</b>	<b>31</b>

## Dear customer,

The controlled grounding principle used in the **TERRALIGHT** Ground Monitoring Device series TERRA-L ensures that static charges developing in potentially explosive atmospheres, e.g. during loading, discharging or refilling are safely avoided. This means that the risk of ignition caused by uncontrolled static discharges is eliminated at source. Because the ground connection is monitored, there is no need for low-resistance ground connections or large conductor cross-sections-

Static charges are caused by the contact and separation of material surfaces, e.g. when pumping liquid or powdery materials from one container to another. If no leakage device is available to lead these charges to ground, extremely high charge potentials may develop. Deflagrations or even explosions caused by sparking can result in substantial damage or personal injury.

Objects are considered to be adequately grounded if their ground leakage resistance is not greater than  $10^5 \dots 10^8 \Omega$ . The Eltex TERRA-L ground monitoring device guarantees a safe and reliable ground connection. Used in combination with the Eltex ground clamps and the cable rewinders the device provides the ultimate ground connection.

The TERRA-L components monitor the connection to the bonding conductor and the contact across the ground clamps.

Please read these instructions carefully before starting the unit. This will help you prevent personal injuries and damage to property.

Simply give us a call if you have any suggestions, proposals or ideas for improvements. We greatly appreciate the feedback from the users of our appliances.

# 1. Overview of Appliance TERRA-L Ground Monitoring Device

Ground contactors and cables

Monitoring device

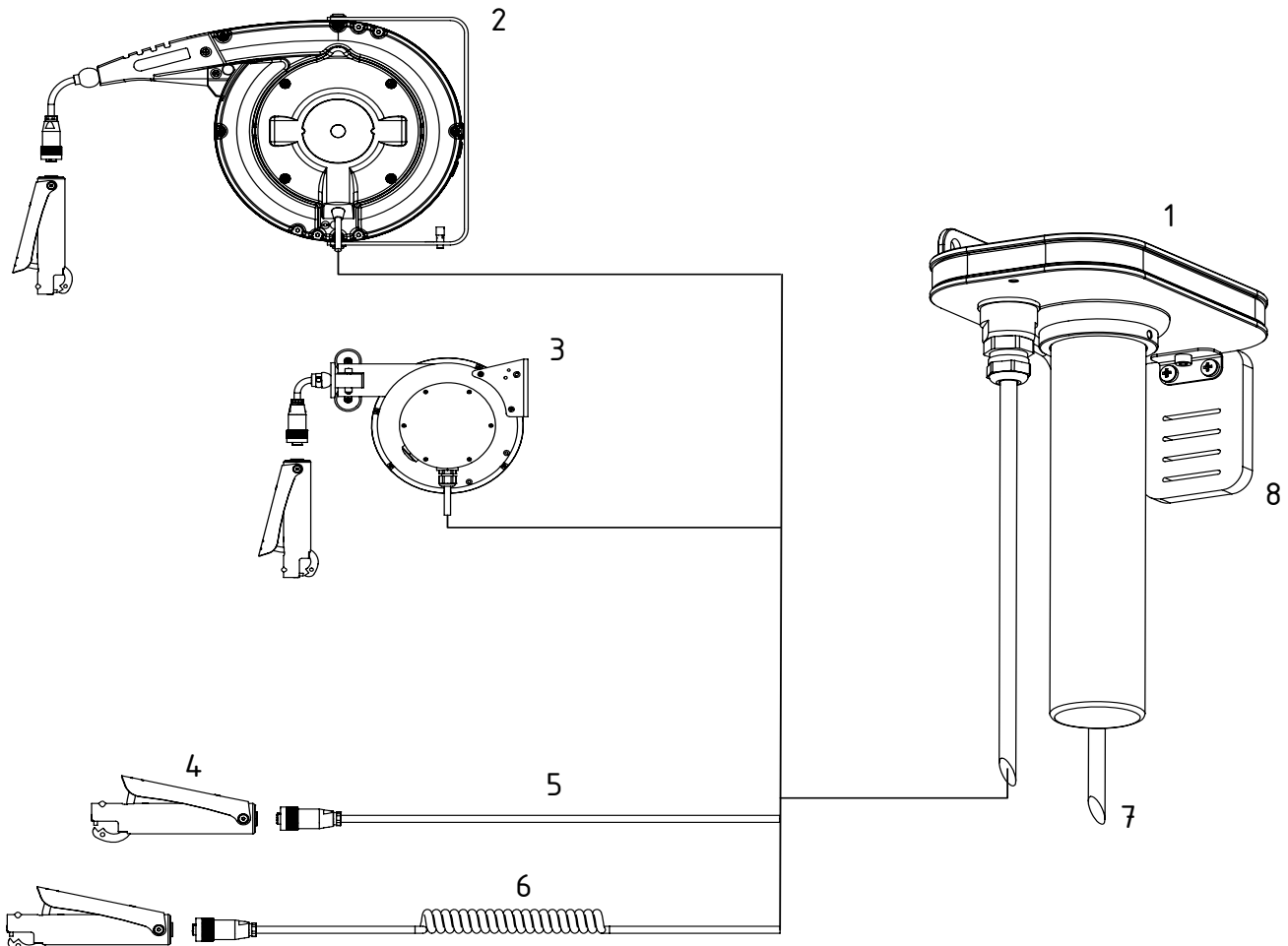

Fig. 1: Overview TERRA-L Ground Monitoring Device

- 1 TERRA-L
- 2 Cable rewriter, aluminum, 601KR/AW and 601KR/DW with ground clamp
- 3 Cable rewriter, plastic, 601KR/KW with ground clamp
- 4 Ground clamp
- 5 Ground cable KG/BNlb
- 6 Helix ground cable KG/BSLB
- 7 PAL connection cable KG/BNLX
- 8 Clamp holder (optional in 2 versions, available as an accessory)

Z-116860ay



## 2. Safety

The units have been designed, built and tested using state-of-the-art engineering, and have left the factory in a technically and operationally safe condition. If used improperly, the units may nevertheless be hazardous to personnel and may cause injury or damage. Read the operating instructions carefully and observe the safety instructions.

For warranty conditions, please refer to the General Terms and Conditions (GTC), see [www.eltex.de](http://www.eltex.de).

### 2.1 Identification of risks and hazards

Possible risks and hazards resulting from the use of the units are referred to in these operating instructions by the following symbols:



#### **Warning!**

This symbol appearing in the operating instructions refers to operations which, if carried out improperly, may result in serious personal injuries.



#### **Caution!**

This symbol appearing in the operating instructions refers to operations which, if carried out improperly, may result in damage to property.



#### **Ex Warning!**

Only for units with Ex approval.

This symbol denotes the special conditions which must be observed when operating the units in explosion hazard areas as specified in the approvals.

### 2.2 Technical advance

The manufacturer reserves the right to make changes to the technical specifications without prior notice in order to adapt the units to state-of-the-art engineering. Eltex will provide the latest information on any changes or modifications in the operating instructions on request.

### 2.3 Proper use

The TERRA-L ground monitoring device must be operated only for the purpose of static ground connection.

The TERRA-L ground monitoring device are designed for operation with specific Eltex contact clamps of the series TERRA-C/xxx and cable rewinders 601KR/\_. These contact clamps provide high degree of safety and the best possible ground connection in terms of static electricity.

The manufacturers will not assume any liability and warranty if the units are used improperly or used outside the intended purpose.

Modifications or changes made to the devices are not permitted.

Use only original Eltex spare parts and equipment.

## 2.4 Work and operational safety



### **Warning!** electricians

Carefully observe the following notes and the complete [Chapter 2 "Safety", page 7!](#)

- The local standards, rules and regulations relating to the installation and operation of electrical appliances in potentially explosive atmospheres must be observed (e.g. EN 60079-14 and EN 60079-17 in the EU and ElexV in Germany).
- Appliances designed for use in potentially explosive atmospheres must not be modified. The technical specifications for ambient conditions and operation must be maintained and observed (see [Chapter 7 "Technical specifications TERRA-L", page 25](#)).
- Observe the type plate with the connection data (supply voltage) of the devices (see [Chapter 4 "Operation", page 21](#)).



- Electrical devices used in explosion hazard areas must at all times be in a technically faultless condition. Any defects must be repaired or remedied immediately (see [Chapter 4 "Operation", page 21](#)).
- Any work involving the units must be carried out by qualified electricians (see [Chapter 3 "Assembly and installation", page 11](#), [Chapter 5 "Maintenance", page 23](#), [Chapter 6 "Troubleshooting", page 24](#)).
- The unit may only be used by qualified personnel trained for explosion hazard areas.



- A "Connect/Disconnect Approval" by the plant operator must be obtained before carrying out any installation, assembly, service, repair or maintenance work in potentially explosive atmospheres. Make sure that a potentially explosive atmosphere does not exist at this instant of time! (see [Chapter 3.2 "Assembly", page 12](#), [Chapter 5 "Maintenance", page 23](#), [Chapter 6 "Troubleshooting", page 24](#)).
- A permanent ground connection must be established via the ground terminal. The ground cable must have a minimum cross-section of 4 mm<sup>2</sup> (see [Chapter 3.3 "Grounding", page 13](#)).
- Intrinsically safe circuits must be routed separately from non-intrinsically safe circuits (separate cable conduits/ducts).
- Crossing intrinsically safe and non-intrinsically safe leads is not permitted (see [Chapter 3.4.1 "Cable connection", page 14](#)).
- When connecting the cables, pay attention to the correct length of the stripped section and the position within the connecting adapter (see [Chapter 3.4.1 "Cable connection", page 14](#)).
- Incorrect connector assignment may lead to an inadvertent release, especially in combination with the light plug (see [Chapter 3.5 "Terminal assignments", page 19](#)).





- The maximum cable length in the intrinsically safe circuit must not exceed the maximum permissible capacity and inductance (see [Chapter 7 "Technical specifications TERRA-L", page 25](#)).
- The ground monitoring device must always be connected to the equipotential bonding conductor (see [Chapter 3.4.1 "Cable connection", page 14](#)).
- If the ground cable is subjected to tensile stress in the application (e.g. if KG/BN\_ (ground cable) or KG/BS\_ (helix ground cable) is used), the cable must be secured additionally with an external strain relief (e.g. a strap clip); see [Chapter 3.4.1 "Cable connection", page 14](#).
- An equipotential bonding connection (PA) must be established along the entire intrinsically safe measuring circuit (see [Chapter 4 "Operation", page 21](#)).
- If all connections (supply voltage, ground clamps etc.) have been made correctly and the battery is inserted, the device is operational (see [Chapter 4.1 "Start-up", page 21](#)).
- Once the TERRA-L ground monitoring device has been assembled and installed, it must be tested for proper functioning (see [Chapter 4.3 "Function control", page 22](#)).
- Check the ground monitoring devices at regular intervals for proper function, in doing so check the operating points (see [Chapter 5.1 "Ground monitoring devices", page 23](#)).
- Cables and clamps must not be damaged. Damaged cables and clamps must be replaced with new parts (see [Chapter 5 "Maintenance", page 23](#)).
- To make sure that the proper ground connection exists with the equipotential bonding and that no malfunctions occur, the ground clamp must be cleaned when dirty (see [Chapter 5.2 "Ground clamps", page 23](#)).
- Perform regular checks to ensure that the cable and the insulation show no tears or abrasion that could impair the cable's insulation or functioning (see [Chapter 5.3 "Cable rewinders", page 23](#)).
- The optionally available balancers (article no. 116738 and 116740) can be used in gas groups IIA, IIB and IIC, zone 0 and zone 20.



## 2.5 Special conditions according to the declaration of conformity

- Only the following battery types (D cells) may be used to operate the TERRA-L device:
  - Duracell Plus Power MN1300
  - Procell Constant PC1300
  - Procell Intense PX1300(see [Chapter 3.4.2 "Battery change \(Fig. 6\) / Battery disposal", page 16](#)).
- The batteries may only be replaced if it can be ensured that a potentially explosive atmosphere does not exist at this instant of time (see [Chapter 3.4.2 "Battery change \(Fig. 6\) / Battery disposal", page 16](#)).
- Equipotential bonding (PA) shall be established along the entire cable run of the measuring circuit (see [Chapter 4 "Operation", page 21](#)).
- In areas where dust can form explosive atmospheres, only correspondingly certified and marked ("D") equipment may be connected to the measuring circuit.
- In areas where gas can form explosive atmospheres, simple electrical apparatus like clamps and cable rewinders may be connected to the measuring circuit. The simple apparatus must comply with the appropriate requirements of EN 60079-11, but must not be certified and marked.

### 3. Assembly and installation



#### Attention!

Once the TERRA-L ground monitoring device has been assembled and installed, it must be tested for proper functioning, see chapter 4.3.

#### 3.1 View of appliance TERRA-L

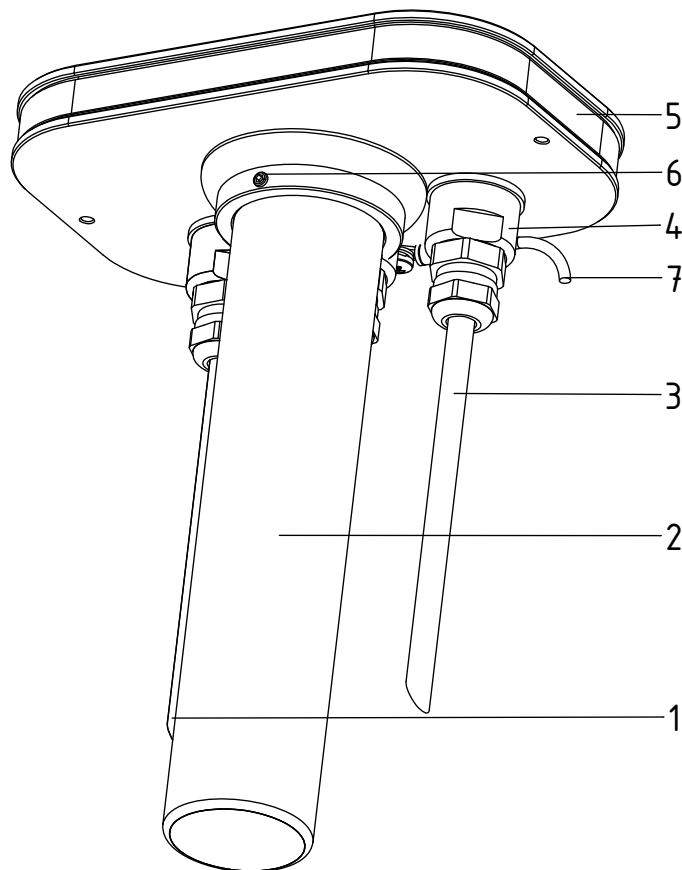

Fig. 3:  
View of appliance  
TERRA-L

- 1 Connection of the ground contactor / cable retractor
- 2 Battery case
- 3 Connection PAL
- 4 Adapter with cable gland
- 5 Signal light (surrounding)
- 6 Locking screw against unintentional opening of the battery compartment
- 7 Ground connection

Z-116536y

### 3.2 Assembly



When installing the device in explosion hazard areas, every precaution must be taken to ensure that a potentially explosive atmosphere does not exist at this instant of time!

The TERRA-L ground monitoring device is approved for assembly and installation in potentially explosive atmospheres. The device is designed for wall mounting and is attached with the mounting brackets.

The point of installation must be dry and the indicator lamp must remain in full view. Avoid direct exposure to sunlight.

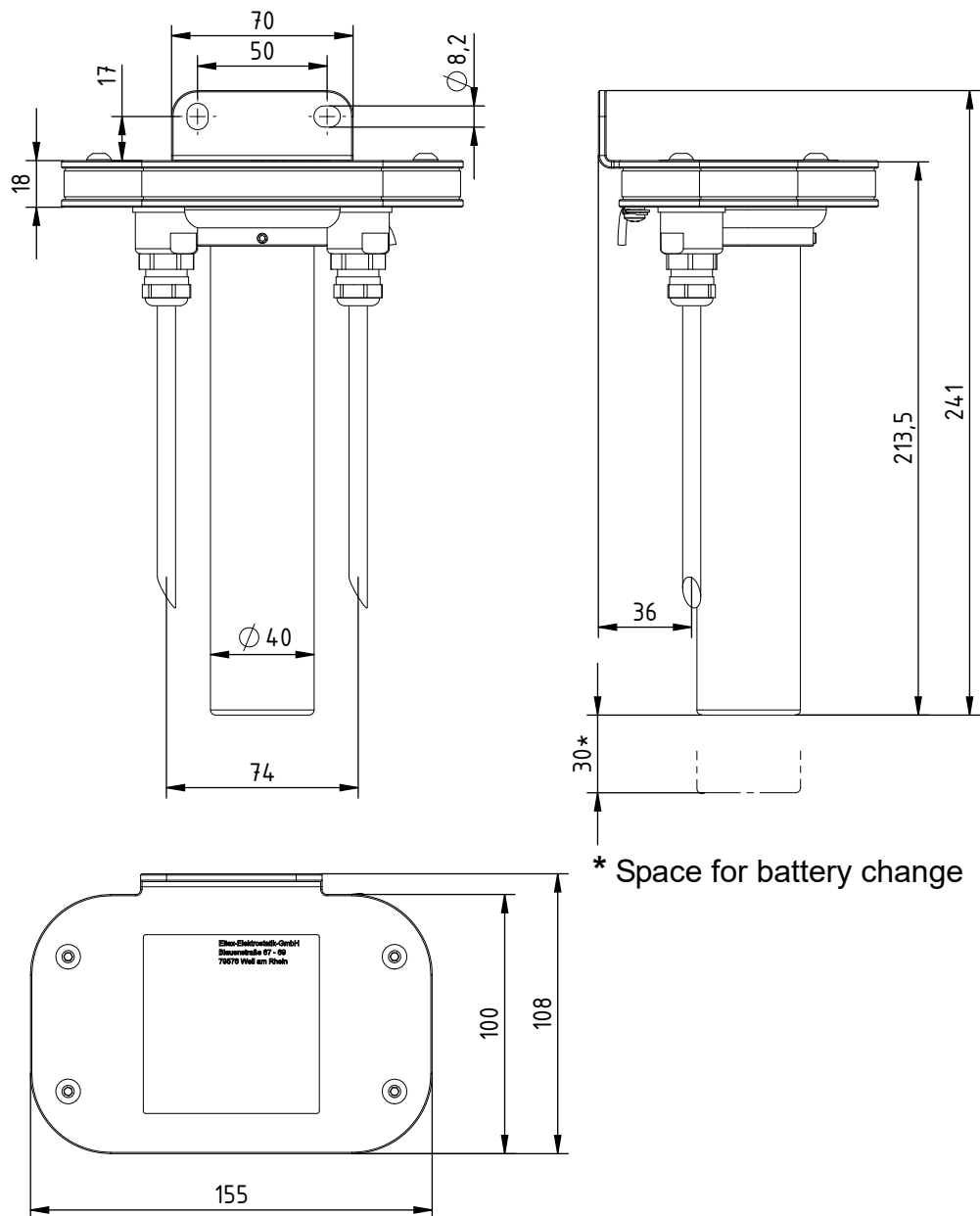

Fig. 4:  
Mounting  
Dimensions  
TERRA-L

### 3.3 Grounding



#### Attention!

A permanent ground connection must be established via the ground terminal (Fig. 5). The ground cable must have a minimum cross-section of 4 mm<sup>2</sup>.

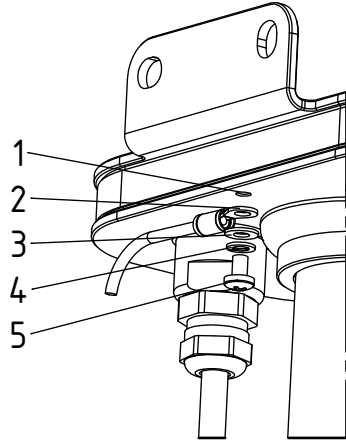

- 1 M4 thread in the housing
- 2 Ground lead with ring terminal
- 3 Washer
- 4 Spring
- 5 M4x6 screw

Fig. 5:  
Grounding  
connection

Z-116536by\_10

### 3.4 Electrical connection



When installing the device in explosion hazard areas, every precaution must be taken to ensure that a potentially explosive atmosphere does not exist at this instant of time!

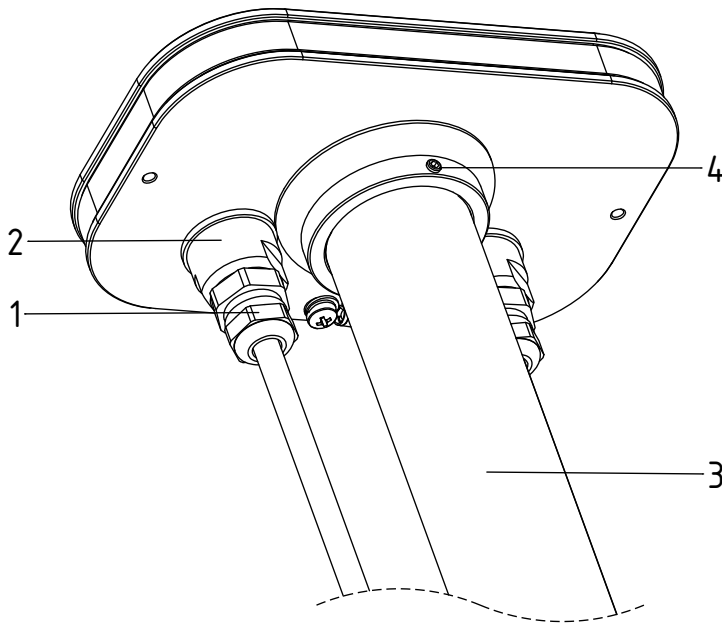

Fig. 6:  
Mounting  
Dimensions  
TERRA-L

- 1. Cap nut
- 2. Adapter with cable gland
- 3. Battery compartment with thread and locking mechanism
- 4. Locking screw

Z-116536by\_4

### 3.4.1 Cable connection



#### Attention!

When connecting the cables, note the correct length of the stripped section and the position within the connecting adapter.

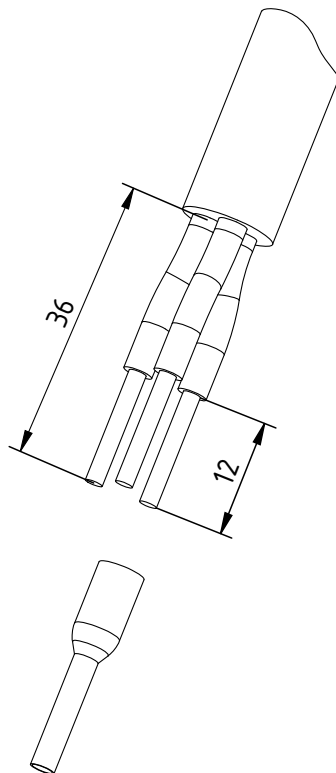

Fig. 7:  
Cable termination

Z-116536by\_11

The wires must be crimped with insulated ferrules (10 mm length). Ideally, a square crimping tool should be used.

The connecting terminals are suitable for a conductor cross-section of 0.2 mm<sup>2</sup> ... 1.5 mm<sup>2</sup>.

The cable glands are designed for a circular cross-section and an external cable diameter of 7.5 ...9.5 mm.

- To connect the cable, first loosen the cap nut (1) at the gland, then unscrew the adapter with the cable gland (2), see Fig. 6.
- Connect the cable as shown in Fig. 8 / Fig. 10.
- Fasten the adapter with the cable gland (2), then tighten the cap nut (1) with a torque of approx. 5 Nm (applies to Eltex grounding cables with an external cable diameter of 8.6 mm). The gasket must not be damaged.
- When using other cables or other cable diameters, the tightening torques must be specified by the user. The cable gland and the cap nut must be tightened firmly.

- Tightening the connection thread or the union nut too loosely or too tightly can impair the type of protection, the tightness and the strain relief



**Attention!**

If the ground cable is subjected to tensile stress in the application (e.g. if KG/BN\_ (ground cable) or KG/BS\_ (helix ground cable) is used), the cable must be secured additionally with an external strain relief (e.g. a strap clip).

A two-core cable for connecting the ground circuit with the PAL bonding lead is routed into the connecting terminal space via the cable inlet (5, 6 Fig. 8 / Fig. 10). The double routing ensures that any disruptions to the PAL bonding lead are identified.

**Note:**

The two PAL leads belong to the intrinsically safe circuit, see cable entry 5, 6 Fig. 8 / Fig. 10.

This is **NO** protective ground link, the leads must **NOT** be coloured green/yellow resp. yellow. The PAL connection can be made with a two-wire sheathed cable, with no wire colours prescribed, i.e., all colours apart from green/yellow resp. yellow are permitted.

The sheathed cable have to be made in light blue or marked accordingly.



The maximum cable length in the intrinsically safe circuit must not exceed the maximum rated capacity and inductance (see Technical Specifications).



The ground monitoring device must always be connected to an equipotential bond.

### 3.4.2 Battery change (Fig. 6) / Battery disposal



The batteries may only be replaced if it can be ensured that a potentially explosive atmosphere does not exist at this instant of time!

- Undo the locking screw (4), then unscrew the battery compartment (3) counter clockwise.
- Replace the batteries; note the correct battery type and polarity.
- Close the battery compartment (3) and re-fasten the locking screw (4). The screw is a protection against inadvertent opening of the battery compartment.

Exhausted batteries may be returned to us or must be disposed of properly.



Only the battery types (D cells) specified in Chapter 2.5 "Special conditions according to the declaration of conformity", page 10 may be used to operate the TERRA-L.



#### **Attention!**

If replacement batteries are not purchased from Eltex, Eltex recommends checking each delivery in accordance with IEC 60079-11 chapter 10.5.2 in order to detect unannounced changes by the battery manufacturer. If the replacement batteries are purchased from Eltex (spare part "battery set" article 116901), this check is carried out by Eltex.



### 3.4.3 Connection TERRA-L

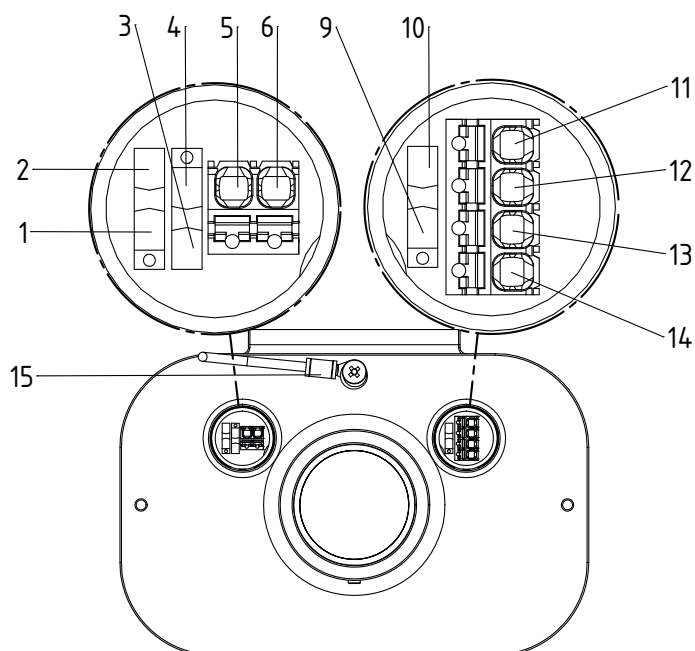

Fig. 8:  
Connection  
TERRA-L

Z-116536by\_3

Position	Function	Labeling electronic parts
Sliding switch 1:		
1	Switch position: steady light	Flash OFF
2	Switch position: flashing	Flash ON
Sliding switch 2:		
3	Switch position: flashing 1 per 3 seconds	3 s
4	Switch position: flashing 1 per 1 second	1 s
5	Connection PAL	PAL
6	Connection PAL	PAL
Sliding switch 3:		
9	Switch position: additional 10 Ohm measurement deactivated	10 Ohm OFF
10	Switch position: additional 10 Ohm measurement activated	10 Ohm ON
11	Connection external LED	LED
12	Connection ground contactor GND	GND
13	Connection ground contactor 2	C2
14	Connection ground contactor 1	C1
15	Ground connection	GND

### 3.4.4 Configuring the sliding switch

There are two sliding switches that offer 3 different setup options for the LED display and one sliding switch for activating / deactivating the 10-ohm measurement:

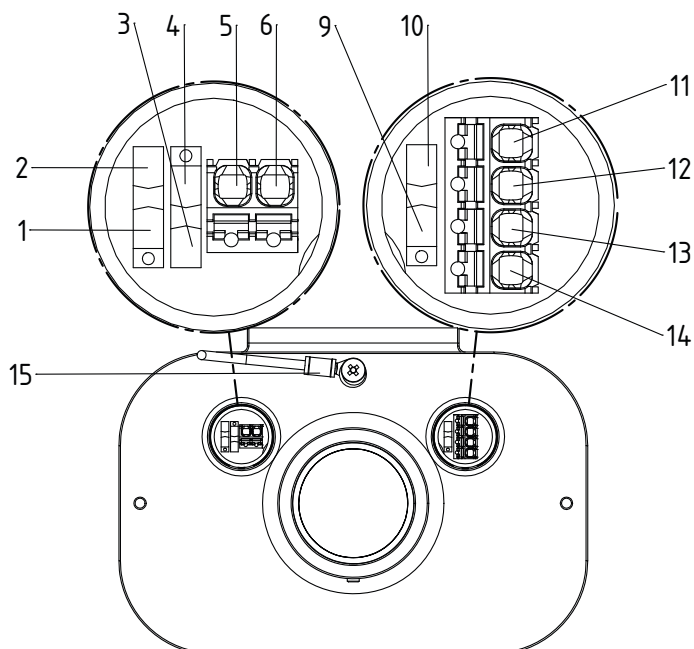

Fig. 9:  
Mounting  
Dimensions  
TERRA-L

#### *Sliding switch 1:*

- Position 1: Steady light  
*Sliding switch 2:* Position 3, 4 without function
- Position 2: Flashing

#### *Sliding switch 2*

- Position 3: Flashing at 0.3 Hz frequency: 1 x / 3 seconds
- Position 4: Flashing at 1 Hz frequency: 1 x / second

#### *Sliding switch 3:*

- Position 9: Additional 10-ohm measurement deactivated
- Position 10: Measurement of leak resistances <10 ohms activated

Z-116536by\_3

### 3.5 Terminal assignments

#### Terminal assignment TERRA-L

Terminal	Connection: PAL
PAL	Equipotential bond
PAL	Equipotential bond
Terminal	Connection: ground contactor
LED	Connection for external LED display
GND	Ground contactor: GND
C2	Ground contactor: Contact 2
C1	Ground contactor: Contact 1
	Connection: battery
	3 x 1.5 V D cells

#### Connection to the cable rewriter

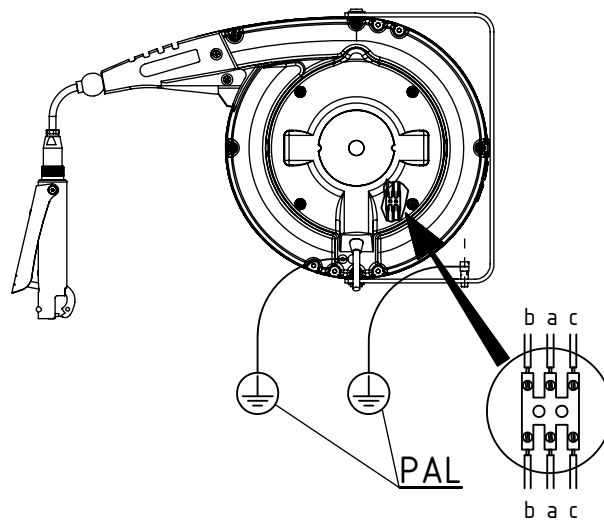
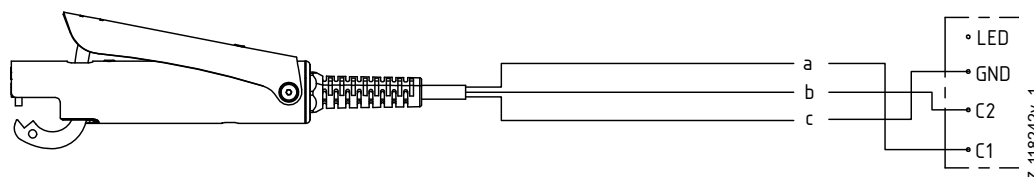

Fig. 10:  
Connection of the  
cable rewriter  
601KR/\_

Z-114868ay\_4

## Connection examples of the ground contactors

**Fig. 11:**  
Connection  
example of the  
ground contactors  
TERRA-L



Wire color: a: blue b: brown c: green/yellow resp. yellow

**Fig. 12:**  
Connection  
example of the  
ground contactors  
TERRA-L  
with integrated  
status LED

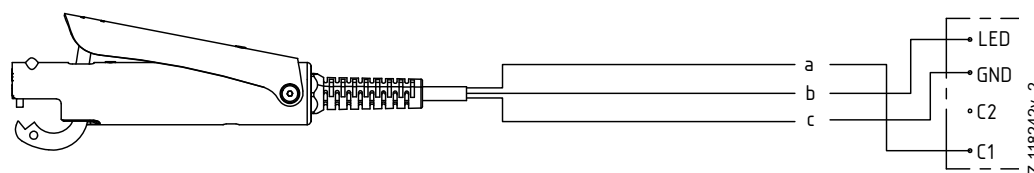

Wire color: a: blue b: brown c: green/yellow resp. yellow



### **Warning!**

Incorrect pin assignment may lead to an inadvertent release, especially in combination with the ground contactors with integrated status LED.

## 4. Operation



### Caution!

Please note the type plate indicating the connection data (supply voltage) of the devices.



- An equipotential bonding connection (PA) must be established along the entire intrinsically safe measuring circuit.
- Electrical devices used in explosion hazard areas must at all times be in a technically faultless condition. Any defects must be repaired or remedied immediately.

### 4.1 Start-up



If all connections (supply voltage, ground clamps etc.) have been made correctly and the battery is inserted, the device is operational.

### 4.2 Function

If the ground contactor has been connected properly and clamped to the container to be grounded and monitored, the intrinsically safe circuit is closed.

This status is indicated by the green steady light or green flashing of the lamp.

The diagram of the TERRA-L ground monitoring device is shown in Fig. 13.

Operating points see chapter 7 "Technical specifications TERRA-L".

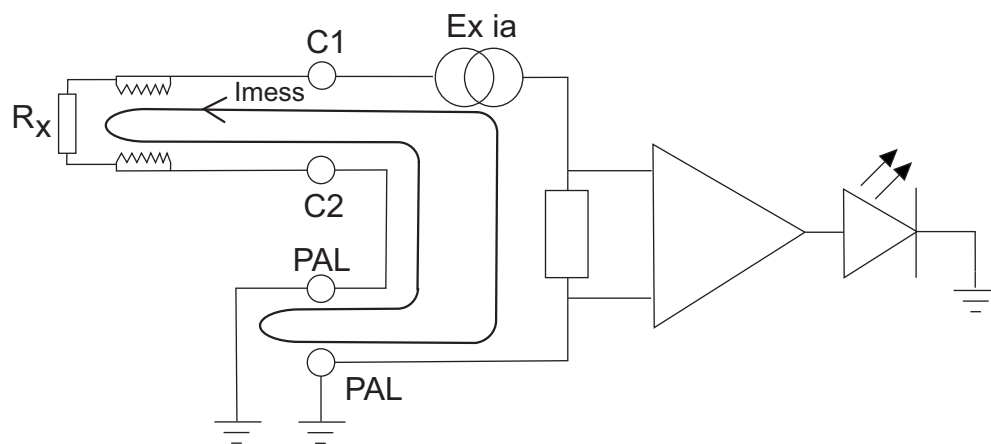

Fig. 13:  
Diagram of the  
TERRA-L ground  
monitoring device

For the operating points, the total resistance is relevant, consisting of  $R_x$ , plus the line resistance of the supply lines to the ground contactors and the PAL lines.

$I_{mess}$  = intrinsically safe measuring circuit

### 4.3 Function control

If the 70AG and 70AK ground clamps are connected to a conductive, non-grounded object, the green operating light signals the enable state and the proper function.

### 4.4 Undervoltage warning

- If the battery voltage is low, the LEDs are yellow instead of green and the external LED is deactivated.
- The device will still function, but the batteries should be changed at the next opportunity.

### 4.5 Battery life

The life of the batteries depends primarily on the frequency of use, the configuration and the environmental conditions. The following table of average values shows the influence of the configuration on the expected battery life.

		groun- ding not detected	grounding detected		
			steady light	1 s - interval	3 s - interval
<b>with external LED</b>	10 Ohm ON	31900 h / 1329 days	235 h /	990 h	2920 h
	10 Ohm OFF		270 h	2180 h	4930 h
<b>without external LED</b>	10 Ohm ON		330 h	1130 h	3020 h
	10 Ohm OFF		400 h	2960 h	6000 h

The stated values apply to continuous operation. If the ground monitoring device is only temporarily active, the life of the batteries increases accordingly.

Example:

Configuration without external LED, 10-ohm measurement OFF, 1-second interval, average use of 8 h / day:

$$2960 \text{ h} : 8 \text{ h / day} = 370 \text{ days}$$

For this reason, the “steady light” option is only recommended for applications in which the TERRA-L device is only used for a short time each day.

## 5. Maintenance



Before carrying out maintenance or service work in the explosion hazard area, make sure that a potentially explosive atmosphere does not exist at this instant of time.



### Warning!

Maintenance and repair work must be carried out only by qualified electricians.

Cables and clamps must not be damaged. Damaged cables and clamps must be replaced with new parts.

### 5.1 Ground monitoring devices



Check the devices at regular intervals for proper function, in doing so check the operating points. The inspection intervals are specified in the accident prevention regulations, as amended (e.g. in Germany DGUV V3). No other maintenance work is required.

#### Checking the operating points

Determine the operating points (see chapter 7 "Technical specifications TERRA-L") by using a decimal resistor.

### 5.2 Ground clamps



To make sure that the proper ground connection exists with the equipotential bonding and that no malfunctions occur, the ground clamp must be cleaned when dirty.

Store the ground clamp such that it cannot be damaged. Replace damaged cables and clamps with new parts. Whenever possible, the ground clamp should either be hung up freely or be clamped to a non-conductive object.

### 5.3 Cable rewinders



Perform regular checks to ensure that the cable and the insulation show no tears or abrasion that could impair the cable's insulation or functioning. Clean the cable with a cloth soaked in warm water to remove dirt or incrustations and ensure perfect unwinding.

Defective devices must be sent in for repair.

## 6. Troubleshooting



Before carrying out maintenance or service work in the explosion hazard area, make sure that a potentially explosive atmosphere does not exist at this instant of time.



### Warning!

Maintenance and repair work must be carried out only by qualified electricians.

Error/Symptom	Remedy
LEDs on the TERRA-L device lights up yellow.	Low battery voltage; the function is still given, a timely battery replacement is recommended.
Lighting LEDs on the TERRA-L device, although the ground clamp has not been clamped to a conductive object.	Dirt settled on ground clamp: Clean ground clamp with solvent (cleaning gasoline). Do not immerse the plug of the coupling in solvent.
Lighting LEDs on the TERRA-L device after attaching the clamp to a conductive and grounded object, although the connections to terminals C2 and/or PAL are disrupted.	No error! The unit identifies the ground connection of the object and enables.
No LED display, because the cable ripped from the plug or from the clamp.	Shorten cable and reconnect (see Electrical Connections)
Cable break on the cable rewinder.	Shorten cable and reconnect (see Electrical Connections).



## 7. Technical specifications TERRA-L

entsprechend  
Geräte-  
kennzeichnung:



Supply voltage	supply via 3 x 1.5 V D cells yellow LEDs indicate a low battery voltage
Operating ambient temperature	-18...+50 °C (-0-4...+122 °F)
Storage temperature	-40...+80 °C (-40...+176 °F), without battery
Ambient humidity	max. 80 % r.h., non-dewing
Enclosure material	stainless steel with wall bracket
Protection class	IP65 according to EN 60529
Dimensions	240.5 x 155 x 108 mm (H x W x D), see Fig. 14
Weight	1.75 kg
Measurement circuit	intrinsically safe according to EN 60079-11 maximum voltage $U_0$ : 5.2 V DC maximum current $I_0$ : 0.22 A maximum output $P_0$ : 0.27 W maximum permissible connected load (capacity / inductance): $C_0$ : 2.19 $\mu$ F, $L_0$ : 1000 $\mu$ H
Operating points	ON <20 kOhm, OFF >50 kOhm / $\pm$ 20 %
Permitted battery types (D cells)	Duracell Plus Power MN1300 Procell Constant PC1300 Procell Intense PX1300
Approval / Marking	PTB 18 ATEX 2005 X II 1G Ex ia IIC T4 Ga, II 1D Ex ia IIIC T135°C Da IECEX: PTB 24.0002X Ex ia IIC T4 Ga, Ex ia IIIC T135°C Da

The maximum connectable total cable length to the TERRA-L ground monitoring device is 200 m.



### Attention!

If replacement batteries are not purchased from Eltex, Eltex recommends checking each delivery in accordance with IEC 60079-11 chapter 10.5.2 in order to detect unannounced changes by the battery manufacturer. If the replacement batteries are purchased from Eltex (spare part "battery set" article 116901), this check is carried out by Eltex.

## 8. Dimensions

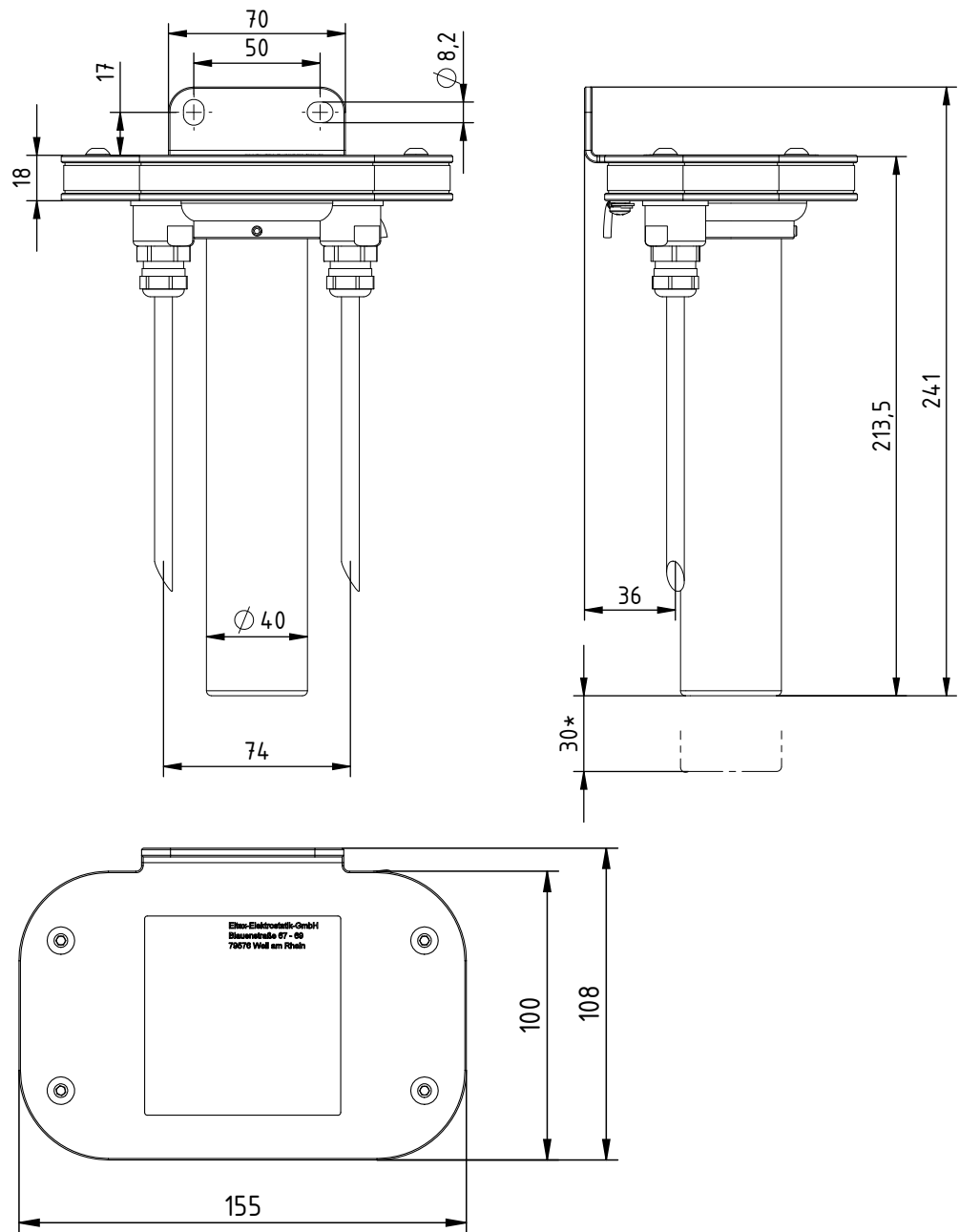
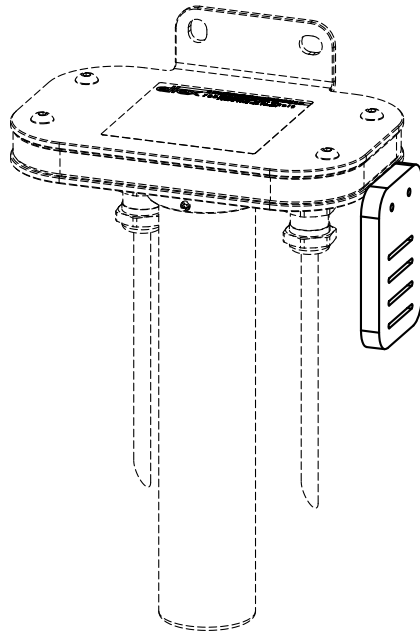

Fig. 14:  
Dimensions  
TERRA-L

Z-116538by\_5+7



Mounting is possible on the right or the left side of the TERRA-L

Abb. 15:  
Clamp holder  
mounting on  
TERRA-L

Z-116742y\_1

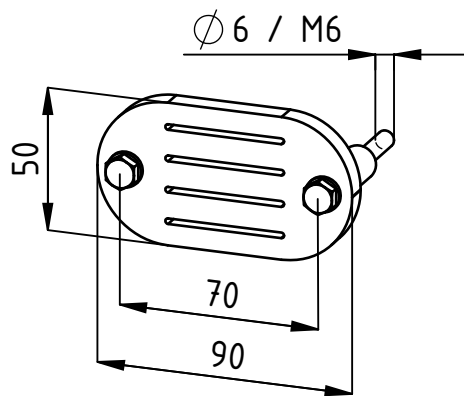

Fig. 16:  
Clamp holder  
mounting on wall

Z-116742y\_2

## 9. Accessories and spare parts

Article	Article-No.
Light plug	116189
Ground clamp Cable color: light blue with coupling connector or with fixed lead length of 3, 6, 9, 12, 15 or 18 m (specify length) and cable end prefabricated, for connection to TERRA-L: - stripped, braids are fitted with wire end sleeves - coupling connector - coupling socket or with fixed helix lead length of 5 or 10 m (specify length) and cable end prefabricated: - stripped, braids are fitted with wire end sleeves - coupling connector - coupling socket	TERRA-C/SOS
Ground clamp with integrated LED status display Cable color: light blue with coupling connector or with fixed lead length of 3, 6, 9, 12, 15 or 18 m (specify length) and cable end prefabricated, for connection to TERRA-L - stripped, braids are fitted with wire end sleeves - coupling connector - coupling socket or with fixed helix lead length of 5 or 10 m (specify length) and cable end prefabricated: - stripped, braids are fitted with wire end sleeves - coupling connector - coupling socket	TERRA-C/SLS
Ground clamp, large with coupling plug IP67 and 300 mm ± 50mm lead length or without plug and lead length as specified (3, 6, 9, 12, 15 or 18 m) or without plug and helix lead length as specified (5 or 10 m)	70AG
Ground clamp, small with coupling plug IP67 and 300 mm ± 50mm lead length or without plug and lead length as specified (3, 6, 9, 12, 15 or 18 m) or without plug and helix lead length as specified (5 or 10 m)	70AK
Cable rewriter, aluminum, 3.0 meters connecting cable, 20 meters ground cable with coupling socket IP67 for connecting ground clamps with plug	601KR/AW

Article	Article-No.
Cable rewriter, aluminum, 3.0 meters connecting cable, 12 meters ground cable with coupling socket IP67 for connecting ground clamps with plug	601KR/DW
Cable rewriter, plastic, 3.0 meters connecting cable, 9 meters ground cable with coupling socket IP67 for connecting ground clamps with plug	601KR/KW
Function testing device TERRA-TU	TERRA-TU
Helix ground cable, 3-pin with coupling IP67 for connecting ground clamps with coupling socket and wire end sleeve, extensible 1 to 5 m, cable color: light blue	KG/BSLB050
Helix ground cable, 3-pin with coupling IP67 for connecting ground clamps with coupling socket and wire end sleeve, extensible 2 to 10 m, cable color: light blue	KG/BSLB100
Ground cable, 3-pin with coupling IP67 for connecting ground clamps with coupling socket and wire end sleeve, 5 to 95 m in steps of 5 meters (specify cable length), cable color: light blue	KG/BNLB_ _ _
PAL connection cable, 3-pin, one-sided pre-assembled, for connection to TERRA-L with wire end sleeves, 5 to 95 m in steps of 5 meters (specify cable length), cable color: light blue	KG/BNLX_ _ _
3-pin ground cable (specify cable length)	LEI00009
Coupling socket, 4-pin, IP67 (side: cable rewriter)	ELM00714
Coupling plug, 4-pin, IP67 (side: clamp)	ELM00713
Cable gland (V2A) with adapter	116902
Cable gland (Ms nickel-plated) with adapter	116903
Battery set (3 pieces, 1.5 V D cells)	116901
Battery compartment with thread	116904
Clamp holder, mounting on TERRA-L	116738
Clamp holder, mounting on wall	116740
Operating Instructions (specify language)	BA-xx-4013

Please specify the article number when ordering.



# EU-Declaration of Conformity

CE-4013-en-2402\_TERRA-L



Eltex-Elektrostatik-Gesellschaft mbH  
Blauenstraße 67 - 69  
D-79576 Weil am Rhein



declares in its sole responsibility that the product

## TERRALIGHT TERRA-L Ground Monitoring Device (according to Eltex reference code)

Identification:  II 1G Ex ia IIC T4 Ga and II 1D Ex ia IIIC T135°C Da  
Certification-no. PTB 18 ATEX 2005 X  
Notified body : Physikalisch-Technische Bundesanstalt, Bundesallee 100, 38116 Braunschweig, NB No. 0102

complies with the following directives and standards.

Relevant EU-Directive:

**2014/34/EU**

Directive: Equipment or Protective System intended for use in potentially explosive Atmospheres

Harmonized standards applied:

EN IEC 60079-0:2018  
EN 60079-11:2012  
IEC 60079-11:2023

Explosive atmospheres – Equipment – General requirements  
Explosive atmospheres – Equipment protection by intrinsic safety "i"  
Explosive atmospheres – Equipment protection by intrinsic safety "i"

Relevant EU-Directive:

**2014/35/EU**

Low Voltage Directive

Harmonized standard applied:

EN 60204-1:2018

Safety of machinery – Electrical equipment of machines – General requirements

Relevant EU-Directive:

**2014/30/EU**

EMC Directive

Harmonized standards applied:

EN 55011:2016 + A1:2017  
+ A11:2020 + A2:2021  
EN IEC 61000-6-2:2019

Industrial, scientific and medical equipment – Radio-frequency disturbance characteristics – Limits and methods of measurement  
Electromagnetic compatibility (EMC) – Generic standards – Immunity for industrial environments

Relevant EU-Directive:

**2011/65/EU**

RoHS Directive

in the version effective at the time of delivery.

Eltex-Elektrostatik-Gesellschaft mbH keep the following documents for inspection:

- proper operating instructions
- plans
- other technical documentation

Weil am Rhein, 15.02.2024  
Place/Date

  
Lukas Hahne, Managing Director

# Eltex offices and agencies

The addresses of all  
Eltex agencies can be  
found on our website at  
[www.eltex.de](http://www.eltex.de)



z01007y



Eltex-Elektrostatik-Gesellschaft mbH  
Blauenstraße 67-69  
79576 Weil am Rhein | Germany  
Phone +49 (0) 7621 7905-422  
eMail [info@eltex.de](mailto:info@eltex.de)  
Internet [www.eltex.de](http://www.eltex.de)